

41-05 29th Street

QUEENS NY, 11101
LONG ISLAND CITY



41-05

29th Street

Queens, NY 11101 | Long Island City
The corner of 29th Street and 41st Avenue

GROUND FLOOR (approx.)
2,407 Square Feet

CEILING HEIGHT
18 FT

FRONTAGE (approx.)
163 FT wraparound

POSSESSION
Immediate

ASKING PRICE
Upon Request

COMMENTS

- At the base of an 86-unit luxury residential tower
- Directly across from Sven Park
- Sidewalk seating opportunity
- Just steps from the Queensboro Plaza station
7, N, W, E, M, R trains

NEIGHBORS

Finback Brewery, Planet Fitness, Fer, City Acres, Hilton Garden Inn, Newcomers High School, Playhouse and many more

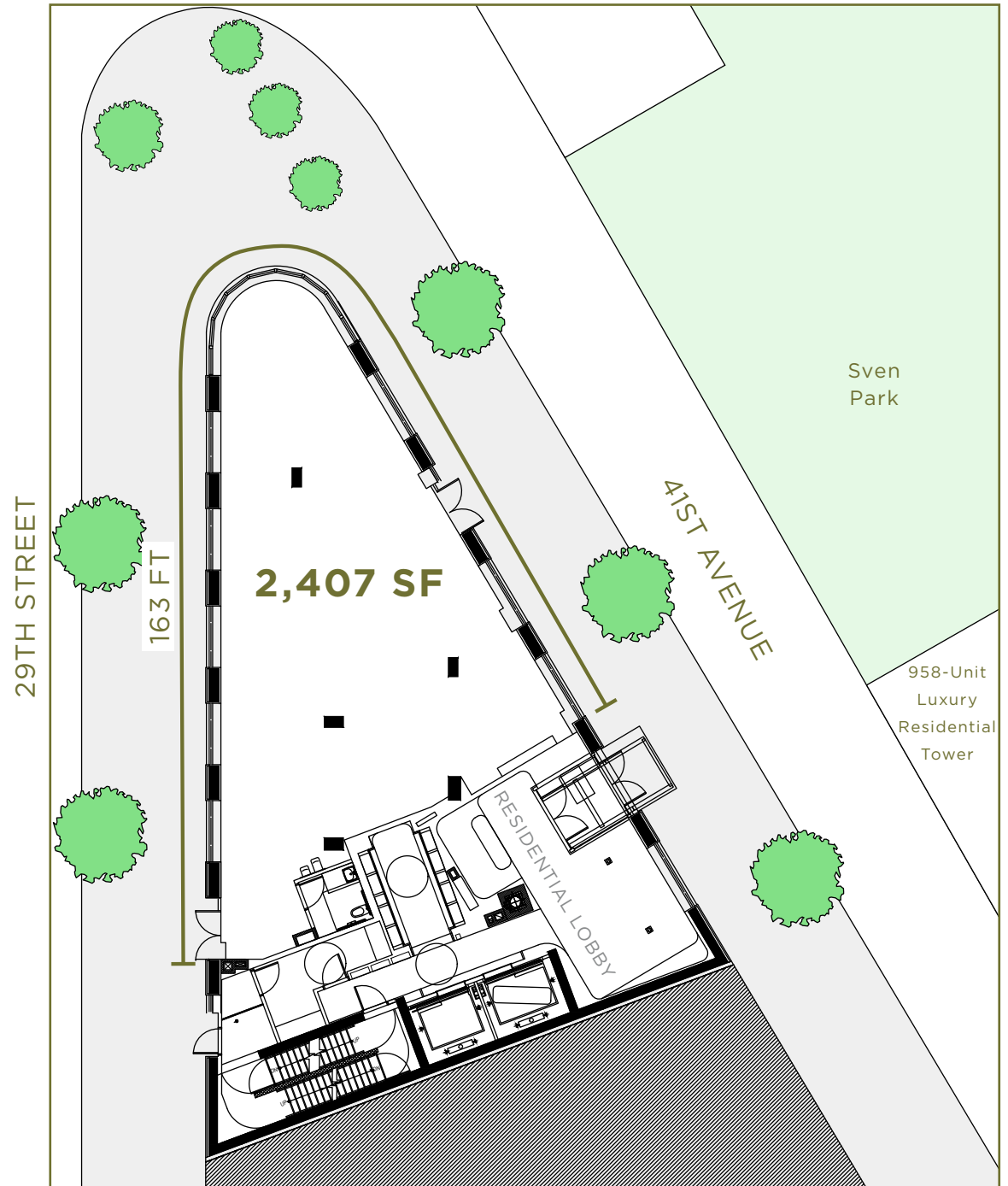



HOTEL

Existing 2023

42 4,300+
Hotels Rooms

Under Construction

38 4,400+
Hotels Rooms

RESIDENTIAL

Existing 2023

33,000+
Units

Under Construction

9,680+
Units

OFFICE / INDUSTRIAL

Existing 2023

11M+ SF
Office / Industrial Space

Under Construction

2.8M+ SF

RETAIL

Existing 2023

1.1M+ SF

Under Construction

318K+ SF



7,000+
Businesses



130K+
Employees



250
Restaurants/Bars/Cafes



50K+
College Students



120K+ SF
Arts & Culture



8
Subway Lines



15
Bus Lines



74
Citibike Docks



4
Bridges

MAP OF NEARBY RETAIL



41-05

29th Street

FOR MORE INFORMATION
PLEASE CONTACT OUR
EXCLUSIVE AGENT:

Thomas Galo

212.792.2602

tgalo@winick.com

WRG | WINICK
REALTY
GROUP

Winick Realty Group LLC, Licensed Real Estate Brokers

655 Third Avenue, 24th Floor | New York, NY 10017

T 212.792.2600 | F 212.792.2660 | winick.com

ALTHOUGH ALL INFORMATION REGARDING PROPERTY FOR SALE, RENTAL OR FINANCING IS FROM SOURCES DEEMED RELIABLE SUCH INFORMATION HAS NOT BEEN VERIFIED, AND NO EXPRESS REPRESENTATION IS MADE NOR IS ANY TO BE IMPLIED AS TO THE ACCURACY THEREOF, AND IT IS SUBMITTED SUBJECT TO ERRORS, OMISSIONS, CHANGE OF PRICE, RENTAL OR OTHER CONDITIONS, PRIOR SALE, LEASE OR FINANCING, OR WITHDRAWAL WITHOUT NOTICE