

393

FIFTH AVENUE

MIDTOWN EAST

393

393

38

393

FIFTH AVENUE

NEW YORK, NY 10016

Between East 36th and 37th Streets

SIZE

Ground Floor	2,000 SF
Basement	1,600 SF

FRONTAGE

32 feet on Fifth Avenue

POSSESSION

Immediate

ASKING PRICE

Upon Request

COMMENTS

- Column free layout with high ceilings
- Formerly the Yankees Clubhouse
- Steps from Herald Square, Bryant Park, and the Empire State Building

GROUND FLOOR

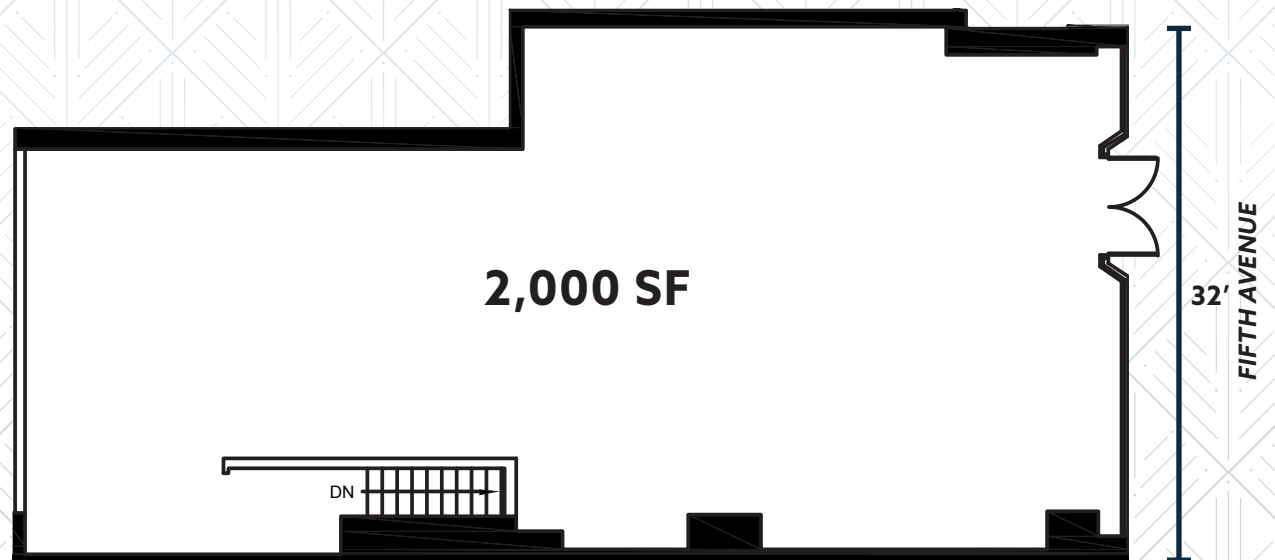

BASEMENT



Bryant Park

HSBC



amazon

MAITTO

CVS pharmacy



NEO

REDKEN



AI FIORI



W Cafe

Rainbow

DUNKIN'

zumiez



CVS pharmacy

The Empire State Building



CHOPT

Walgreens

42nd STREET



ORVIS

ANDAZ



41st STREET

DECIEM

MUJI



40th STREET



I ♥ NY

BRICKWORKS

39th STREET

BRIDAL Reflections

MedMen

SILVER MIRROR FACIAL BAR

38th STREET

ZALES

ASTRO GALLERY

citi Citibank

37th STREET

393 FIFTH AVENUE

★ PRET ★

36th STREET

theVitamin Shoppe

about t:me

I ♥ NY



35th STREET



34th STREET

CHASE

etc.

the sak

33rd STREET

RETAIL MAP

INTERIOR PHOTOS



WRG

WINICK REALTY GROUP

Winick Realty Group LLC, Licensed Real Estate Brokers
655 Third Avenue, 24th Floor | New York, NY 10017
T 212.792.2600 | F 212.792.2660 | winick.com

For more info, please contact our exclusive agents:

Lee Block
212.792.2649
lee@winick.com

Jeff Winick
212.792.2601
jeff@winick.com

Although all information regarding property for sale, rental or financing is from sources deemed reliable such information has not been verified, and no express representation is made nor is any to be implied as to the accuracy thereof, and it is submitted subject to errors, omissions, change of price, rental or other conditions, prior sale, lease or financing, or withdrawal without notice.