

2975 AVENUE U

Northeast Corner of Haring Street | Brooklyn NY, 11229



2975 AVENUE U

Northeast Corner of Haring Street
Brooklyn NY, 11229 | Sheepshead Bay

GROUND FLOOR

6,000 SF

FRONTAGE

Over 100 FT Wraparound

POSSESSION

Immediate

COMMENTS

- Single user building opportunity
- Loading and parking possible on site

NEIGHBORS

Ihop, Starbucks, Dunkin', McDonalds,
Party City, Family Dollar, Walgreens,
Telco Stores, Aldi, Flagstar, TD Bank,
Citizen's Bank

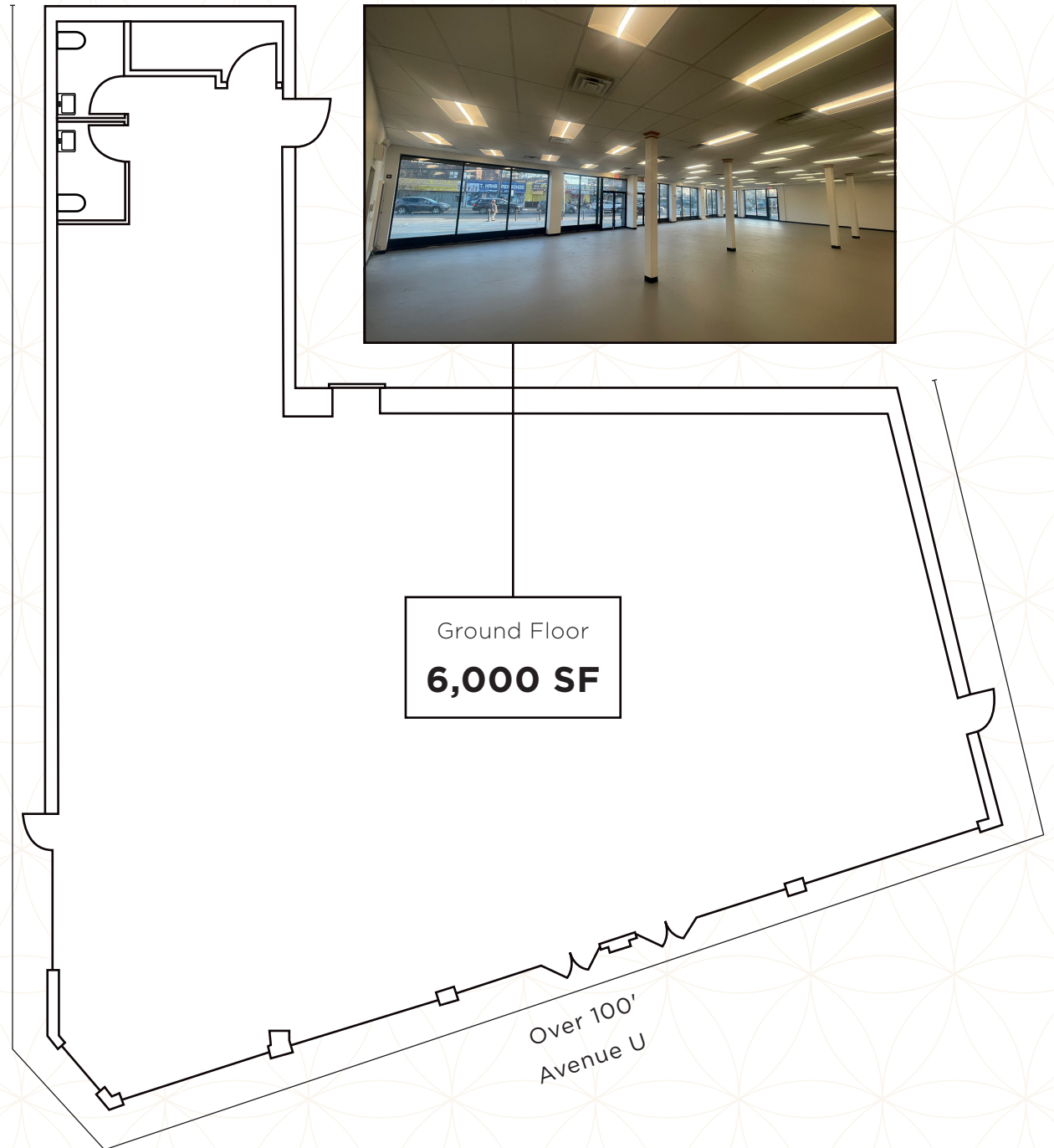

Retail Map



2975 AVENUE U

Northeast Corner of Haring Street
Brooklyn, NY 11229 | Sheepshead Bay

For more information
please contact our exclusive brokers:

Lee Block

212.792.2649
lee@winick.com

Moshe Mizrahi

212.792.2612
mmizrahi@winick.com

WRG | WINICK
REALTY
GROUP

Winick Realty Group LLC, Licensed Real Estate Brokers

655 Third Avenue, 24th Floor | New York, NY 10017

T 212.792.2600 | F 212.792.2660 | winick.com

ALTHOUGH ALL INFORMATION REGARDING PROPERTY FOR SALE, RENTAL OR FINANCING IS FROM SOURCES DEEMED RELIABLE SUCH INFORMATION HAS NOT BEEN VERIFIED, AND NO EXPRESS REPRESENTATION IS MADE NOR IS ANY TO BE IMPLIED AS TO THE ACCURACY THEREOF, AND IT IS SUBMITTED SUBJECT TO ERRORS, OMISSIONS, CHANGE OF PRICE, RENTAL OR OTHER CONDITIONS, PRIOR SALE, LEASE OR FINANCING, OR WITHDRAWAL WITHOUT NOTICE.