

244
WEST 23rd STREET
2TT

CHELSEA
NEW YORK, NY 10011

FITNESS
STUDIO

24 HR. ATM 24 HR. ATM

SPRINKLER
SIAMESE
CONNECTION
FOR FIRE DEPT.

SPRINKLERS
THROUGHOUT
BUILDING

WRG | WINICK
REALTY
GROUP

244 WEST 23rd STREET

BETWEEN SEVENTH AND EIGHTH AVENUES
NEW YORK, NY 10011

GROUND FLOOR (APPROX.)

3,500 SF

FRONTAGE (APPROX.)

25 FT

POSSESSION

IMMEDIATE

ASKING PRICE

UPON REQUEST

COMMENTS

- PRIME CHELSEA LOCATION JUST OFF THE 23RD STREET SUBWAY STOP
- 14 FOOT CEILINGS
- FORMERLY 7-ELEVEN
- IN-BETWEEN TWO HIGH TRAFFIC SUBWAY STATIONS

NEIGHBORS

CINEPOLIS, HOTEL CHELSEA, OPERATION: FALAFEL,
TACO BELL CANTINA, DALLAS BBQ CHELSEA

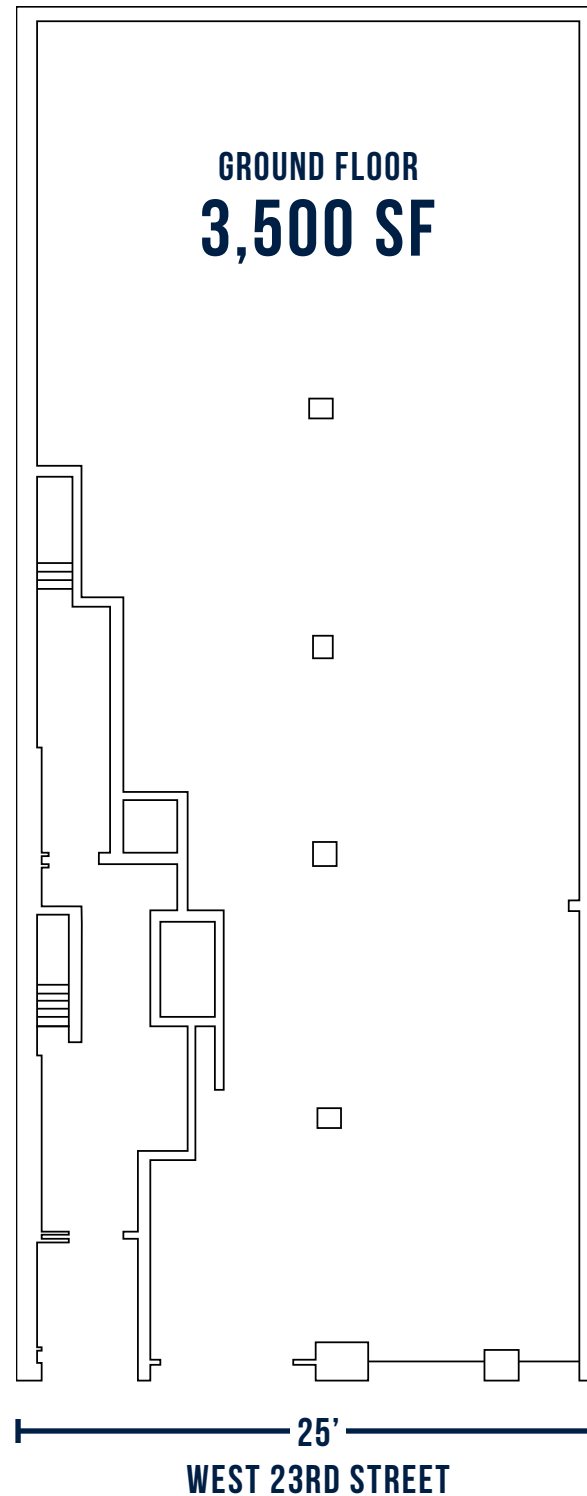

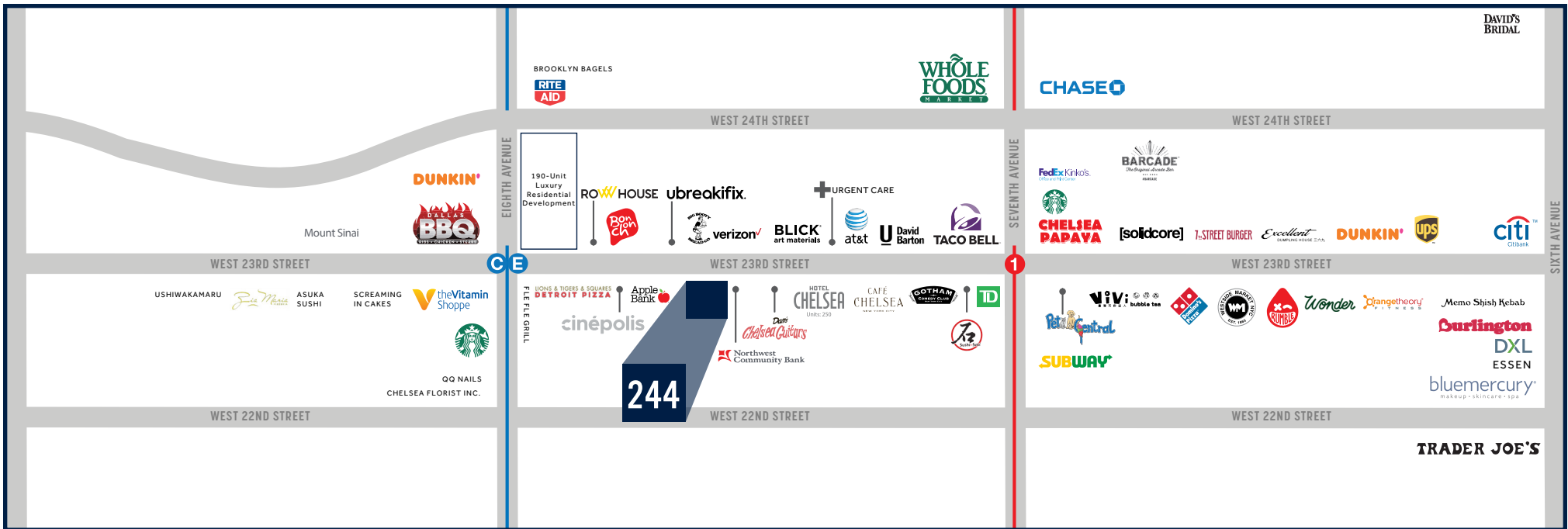

244

WEST 23rd STREET

BETWEEN SEVENTH AND EIGHTH AVENUES
NEW YORK, NY 10011 | CHELSEA

FOR MORE INFORMATION
PLEASE CONTACT OUR EXCLUSIVE BROKERS:

CHARLES RAPUANO

212.792.2658

CHARLES@WINICK.COM

THOMAS GALO

212.792.2602

TGALO@WINICK.COM

STEVEN E. BAKER

212.792.2636

STEVENB@WINICK.COM



**WINICK
REALTY
GROUP**

Winick Realty Group LLC, Licensed Real Estate Brokers
655 Third Avenue, 24th Floor | New York, NY 10017
T 212.792.2600 | F 212.792.2660 | winick.com

ALTHOUGH ALL INFORMATION REGARDING PROPERTY FOR SALE, RENTAL OR FINANCING IS FROM SOURCES DEEMED RELIABLE SUCH INFORMATION HAS NOT BEEN VERIFIED, AND NO EXPRESS REPRESENTATION IS MADE NOR IS ANY TO BE IMPLIED AS TO THE ACCURACY THEREOF, AND IT IS SUBMITTED SUBJECT TO ERRORS, OMISSIONS, CHANGE OF PRICE, RENTAL OR OTHER CONDITIONS, PRIOR SALE, LEASE OR FINANCING, OR WITHDRAWAL WITHOUT NOTICE