

RETAIL **41**
AVENUE D



SIGNAGE

SIGNAGE

WRG | WINICK
REALTY
GROUP

1,600 SF CORNER RETAIL OPPORTUNITY

RETAIL **41**
AVENUE D

Alphabet City | New York, NY 10009

Retail Premises

Ground Floor **1,600 SF** Frontage **80 FT - WRAPAROUND**

Basement **1,600 SF** Ceiling Heights **12 FT**

Possession

Arranged

Asking Price

Upon Request

Comments

- Prime corner retail/restaurant opportunity in Alphabet City
- Currently operating as H&R Block
- Black iron shaft/gas line in-place for cooking users
- New direct lease with ownership
- All uses considered

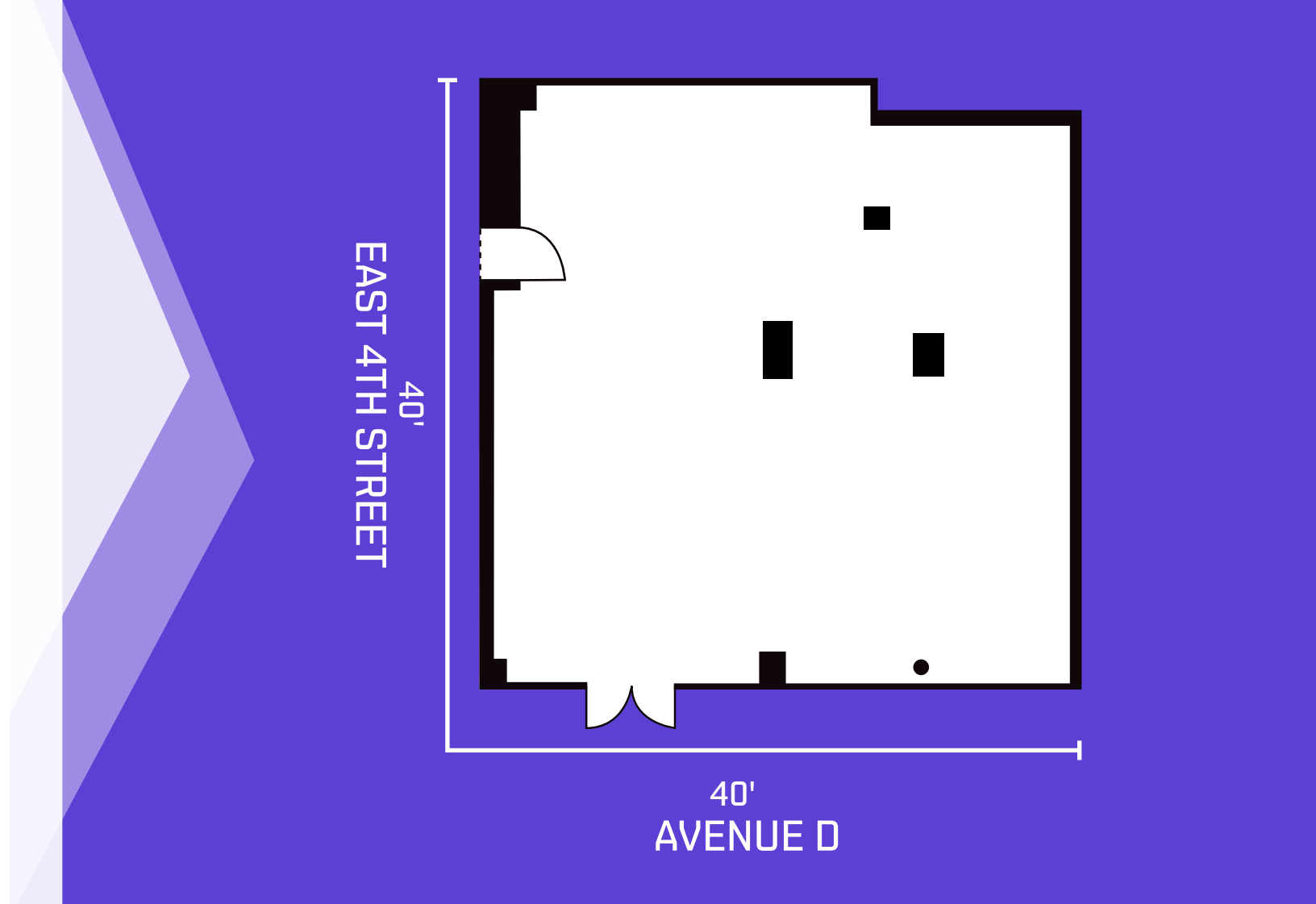

Neighbors



NEIGHBORHOOD RETAILER MAP

Demographics for 10009

1 Mile Radius

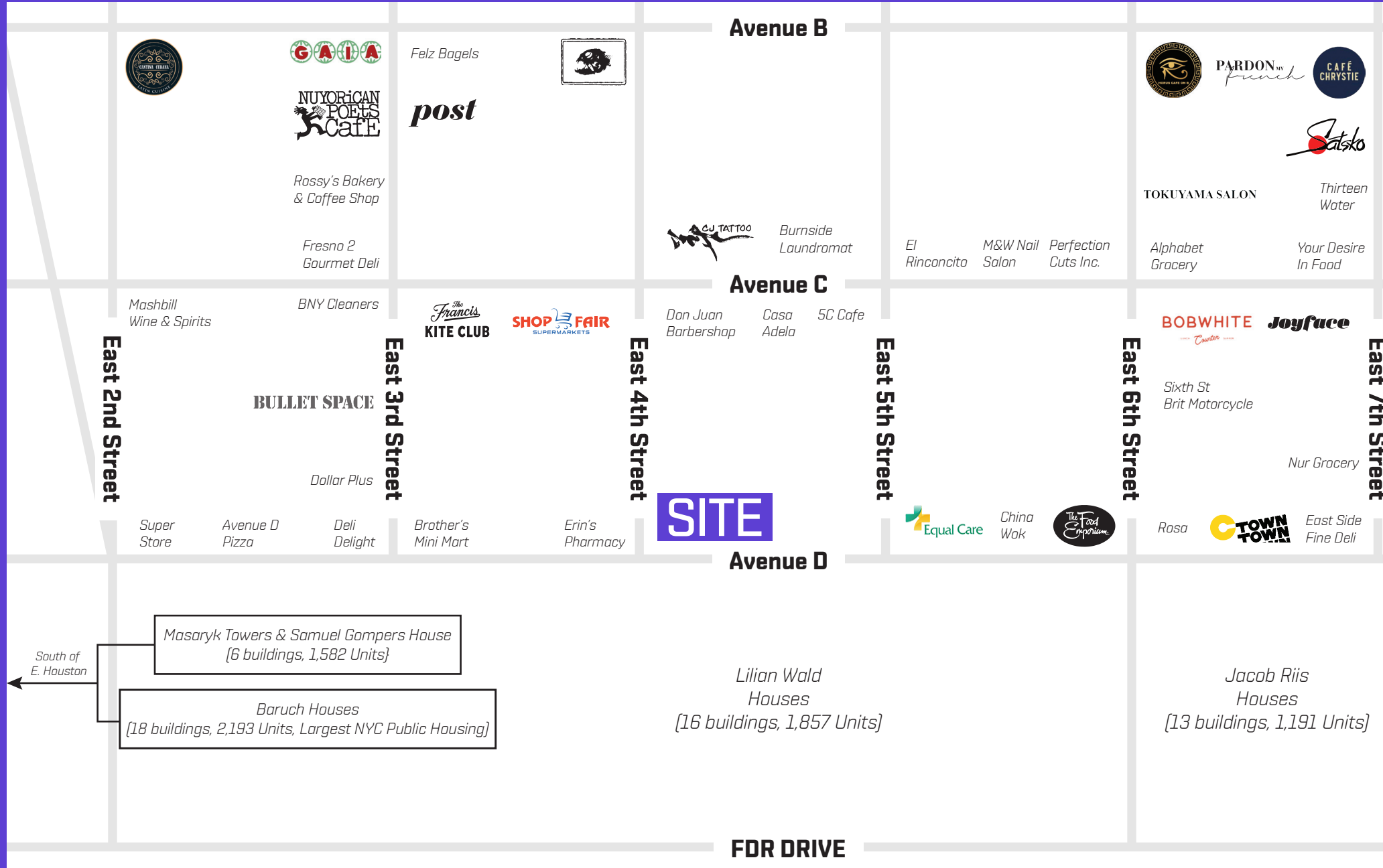

Population
188,054



Total Households
97,735



Household Income
\$139,500



Consumer Spend
\$5.2 B

RETAIL **41**
AVENUE D

For more information, please contact our exclusive agents

MICHAEL SHKRELI

(212) 792-2638

mshkreli@winick.com

ELI GOLD

(212) 792-2626

egold@winick.com



Winick Realty Group LLC, Licensed Real Estate Brokers
655 Third Avenue, 24th Fl New York, NY 10017 | www.winick.com

ALTHOUGH ALL INFORMATION REGARDING PROPERTY FOR SALE, RENTAL OR FINANCING IS FROM SOURCES DEEMED RELIABLE SUCH INFORMATION HAS NOT BEEN VERIFIED, AND NO EXPRESS REPRESENTATION IS MADE NOR IS ANY TO BE IMPLIED AS TO THE ACCURACY THEREOF, AND IT IS SUBMITTED SUBJECT TO ERRORS, OMISSIONS, CHANGE OF PRICE, RENTAL OR OTHER CONDITIONS, PRIOR SALE, LEASE OR FINANCING, OR WITHDRAWAL WITHOUT NOTICE.

