

FINANCIAL DISTRICT

200

PEARL ST

BETWEEN FULTON & JOHN STREETS
NEW YORK, NY 10038



200 PEARL STREET

BETWEEN FULTON & JOHN STREETS NEW YORK, NY 10038

Size

Ground Floor: 1,060 SF
Basement: no basement

Frontage 14 FT of Frontage plus blade signage

Possession Arranged

Highlights

- Located steps from the South Street Seaport entrance and Jean-Georges Tin Building.
- Vented (electric)
- ADA restroom in place

Neighbors

include Hey Thai, Starbucks, Shinjuku Japanese Deli, Duane Reade, 7-Eleven, Call Me Pasta!, Dunkin', Grubbs Cafe, Subway, Carvel Express, Stout NYC, Ryan Maguire's Bar & Restaurant, Jubilee Market, Beatnic, Little Italy Pizzeria, Taco Bell, P.F. Chang's To Go

FOR MORE INFORMATION, PLEASE CONTACT EXCLUSIVE AGENTS

ALEX KARAS
212 792 2656
AKARAS@WINICK.COM

JEFF WINICK
212 792 2601
JEFF@WINICK.COM



WINICK REALTY GROUP LLC
LICENSED REAL ESTATE BROKERS
655 THIRD AVE, 24TH FL NEW YORK, NY 10017 T: 212 792 2600 | W: WWW.WINICK.COM

ALTHOUGH ALL INFORMATION REGARDING PROPERTY FOR SALE, RENTAL OR FINANCING IS FROM SOURCES DEEMED RELIABLE SUCH INFORMATION HAS NOT BEEN VERIFIED, AND NO EXPRESS REPRESENTATION IS MADE NOR IS ANY TO BE IMPLIED AS TO THE ACCURACY THEREOF, AND IT IS SUBMITTED SUBJECT TO ERRORS, OMISSIONS, CHANGE OF PRICE, RENTAL OR OTHER CONDITIONS, PRIOR SALE, LEASE OR FINANCING, OR WITHDRAWAL WITHOUT NOTICE.

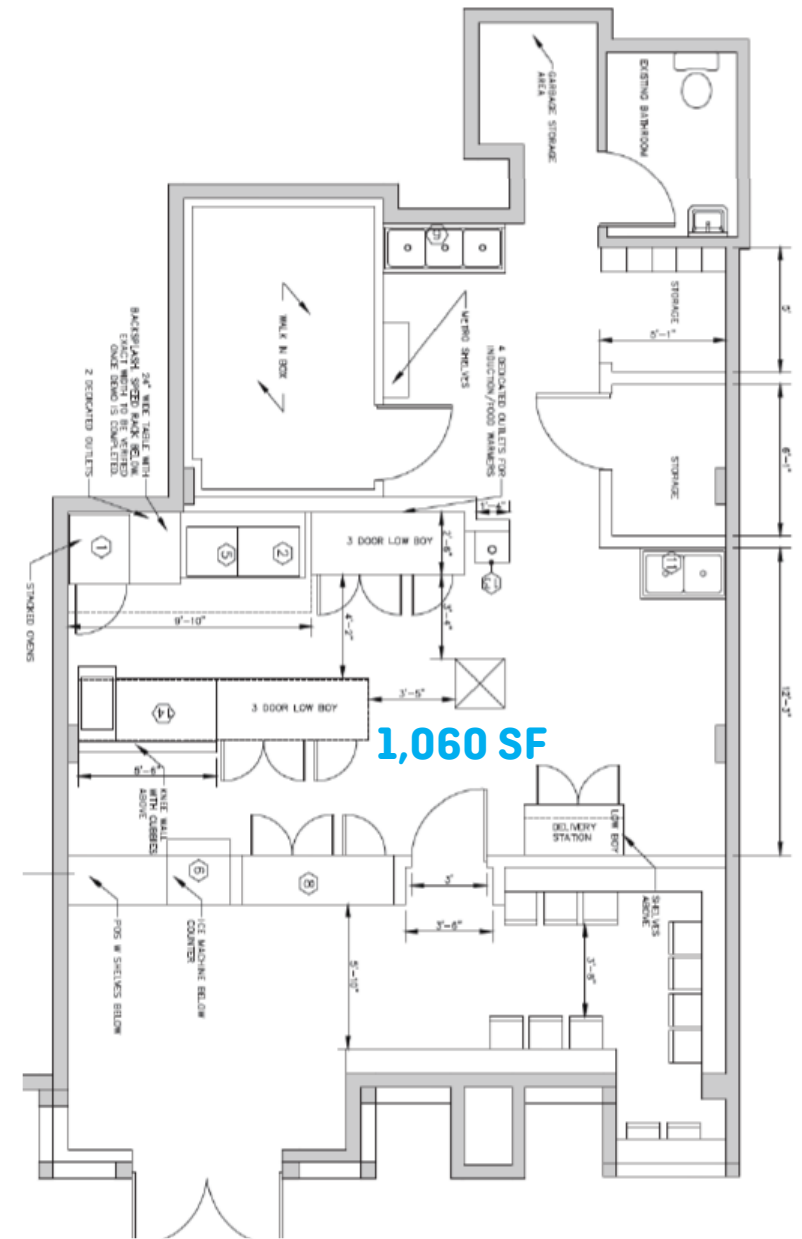

PEARL STREET