

FLATIRON DISTRICT

12

WEST 23RD ST

BETWEEN 5TH & 6TH AVENUES  
NEW YORK, NY 10010





# 12 WEST 23RD STREET

BETWEEN 5TH & 6TH AVENUES - NEW YORK, NY 10010

## Size

Ground Floor: 2,800 SF  
Basement: 1,200 SF (Partial contiguous basement)

Frontage 35 FT of Frontage

Ceiling Heights 15 FT

Possession Arranged

## Highlights

- Located directly across from Eataly and mere steps from Madison Square Park and The Flatiron Building. Surrounded by major transportation
- Turnkey, fully vented and built restaurant space in mint condition
- **Available for sublease**
- HVAC in place with ADA compliant restroom
- Fully sprinklered
- Sidewalk seating
- Currently Veggie Grill
- New \$2M installation in place
- NO KEY MONEY

## Neighbors

Eataly, Lego, Patisserie Chanson, Lenwich, Starbucks, NuLeaf, Deep Indian Kitchen, Verizon, Mangia, Outback Steakhouse, Carrot Express, Home Depot

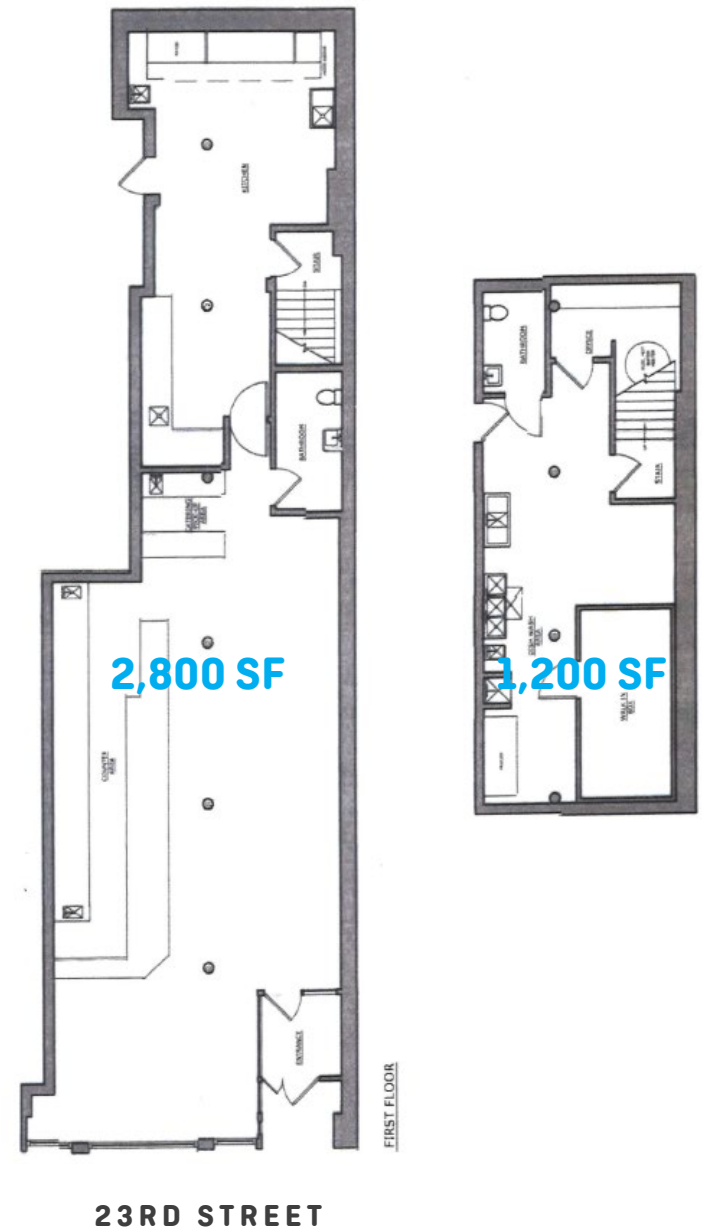

# 12 WEST 23RD STREET



FOR MORE INFORMATION, PLEASE CONTACT  
EXCLUSIVE AGENTS FOR THE SUBLESSOR

ALEX KARAS  
212 792 2656  
AKARAS@WINICK.COM

JEFF WINICK  
212 792 2601  
JEFF@WINICK.COM

**WRG** | WINICK  
REALTY  
GROUP

WINICK REALTY GROUP LLC  
LICENSED REAL ESTATE BROKERS

655 THIRD AVENUE, 24TH FL NEW YORK, NY 10017

T: 212 792 2600 | W: WWW.WINICK.COM

ALTHOUGH ALL INFORMATION REGARDING PROPERTY FOR SALE, RENTAL OR FINANCING IS FROM SOURCES  
DEEMED RELIABLE SUCH INFORMATION HAS NOT BEEN VERIFIED, AND NO EXPRESS REPRESENTATION IS  
MADE NOR IS ANY TO BE IMPLIED AS TO THE ACCURACY THEREOF, AND IT IS SUBMITTED SUBJECT TO ER-  
RORS, OMISSIONS, CHANGE OF PRICE, RENTAL OR OTHER CONDITIONS, PRIOR SALE, LEASE OR FINANCING,  
OR WITHDRAWAL WITHOUT NOTICE.

