

80 MAIDEN LANE

BTW WILLIAM & GOLD STREETS
NEW YORK, NY 10038

FINANCIAL DISTRICT

80 MAIDEN LANE

80 MAIDEN LANE

80 MAIDEN LANE

80 MAIDEN LANE



ADDRESS

80 Maiden Lane
Between William and Gold Streets
New York, New York, 10038

SIZE

Ground Floor: 8,000 SF

ASKING PRICE

Upon Request

POSSESSION

Immediate

COMMENTS

- Formerly occupied by Duane Reade
- Located in the heart of the Financial District with dense residential and office populations nearby
- Office building is being upgraded with newly renovated lobby and infrastructure

NEIGHBORS

AKA Hotel, Blue Ribbon, Felice Wine Bar, Pressed Juice, Soul Cycle, Starbucks, Harry's Italian, Gristedes, Zeytuna, Financier, and many more.

FOR MORE INFORMATION CONTACT EXCLUSIVE AGENT:

LEE BLOCK
212.792.2649
lee@winick.com

WINICK RETAIL
SPECIALISTS

WINICK REALTY GROUP LLC
LICENSED REAL ESTATE BROKERS
655 Third Avenue, 8th Floor, New York, NY 10017
T. 212.792.2600 F. 212.792.2660 winick.com

Although all information regarding property for sale, rental or financing is from sources deemed reliable such information has not been verified, and no express representation is made nor is any to be implied as to the accuracy thereof, and it is submitted subject to errors, omissions, change of price, rental or other conditions, prior sale, lease or financing, or withdrawal without notice.

80 MAIDEN LANE

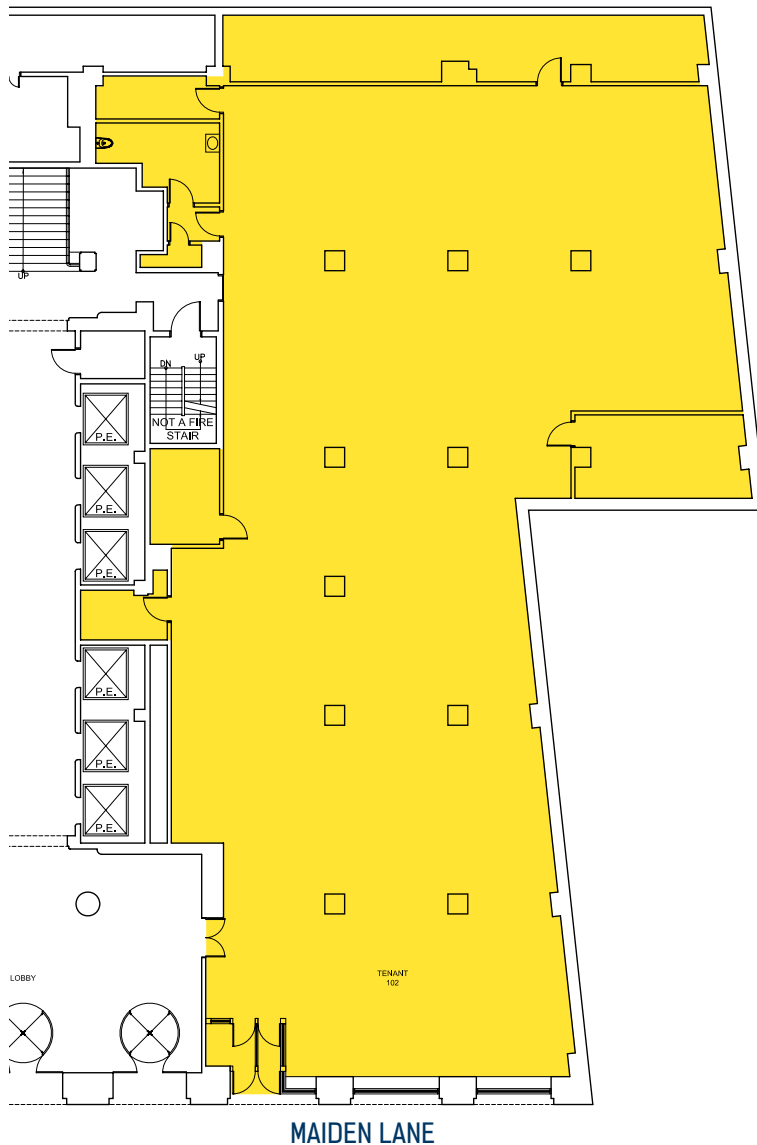

WORK FORCE FACTS

314,832
Employees in Lower Manhattan

96 Million
Square Feet of office space

\$131,085
Average Lower Manhattan salary

\$569 Million
Estimated amount spent in Lower Manhattan each year by employees

RESIDENTIAL FACTS

33,888
Total households in Lower Manhattan

61,000
Total population

\$242,000
Average Lower Manhattan household income

\$3.2 billion
Annual residential disposable income

568
Number of retailers and service businesses in Lower Manhattan

435
Number of restaurants in Lower Manhattan

VISITORS AND TOURISM

14.2 million
Lower Manhattan visitors

Most popular visitor activities
Dining & Shopping

4,092
Existing hotel rooms in Lower Manhattan

5,074
Total anticipated rooms by 2013

MASS TRANSIT

130,000,000
of Annual Ridership

89,788,202
Subway (14 lines, 12 stations)

20,356,772
Staten Island Ferry

4,975,215
Ferries (non-Staten Island)

14,031,675
PATH Train