

BROOKLYN
155
GRAND STREET
11249

Monday
Thursday
8:30am - 10am

RETAIL FOR LEASE

FALAFEL FALAFEL

WINICK

ADDRESS

155 Grand Street
Between Bedford Avenue & Berry Street
Brooklyn, New York 11249

SIZE

Ground: 1,400 SF
Basement: 1,000 SF

FRONTAGE

20 Feet on Grand Street

ASKING RENT

Upon Request

POSSESSION

Immediate

COMMENTS

- Located In the heart of Williamsburg
- Formerly operating as Feltraiger
- All uses considered, venting possible

NEIGHBORS

Supreme, Paul Smith, Apple, Whole Foods, Fool's Gold, Lazy Lash, Salt + Charcoal, Package Free, Grand Street Local, Black Brick Coffee

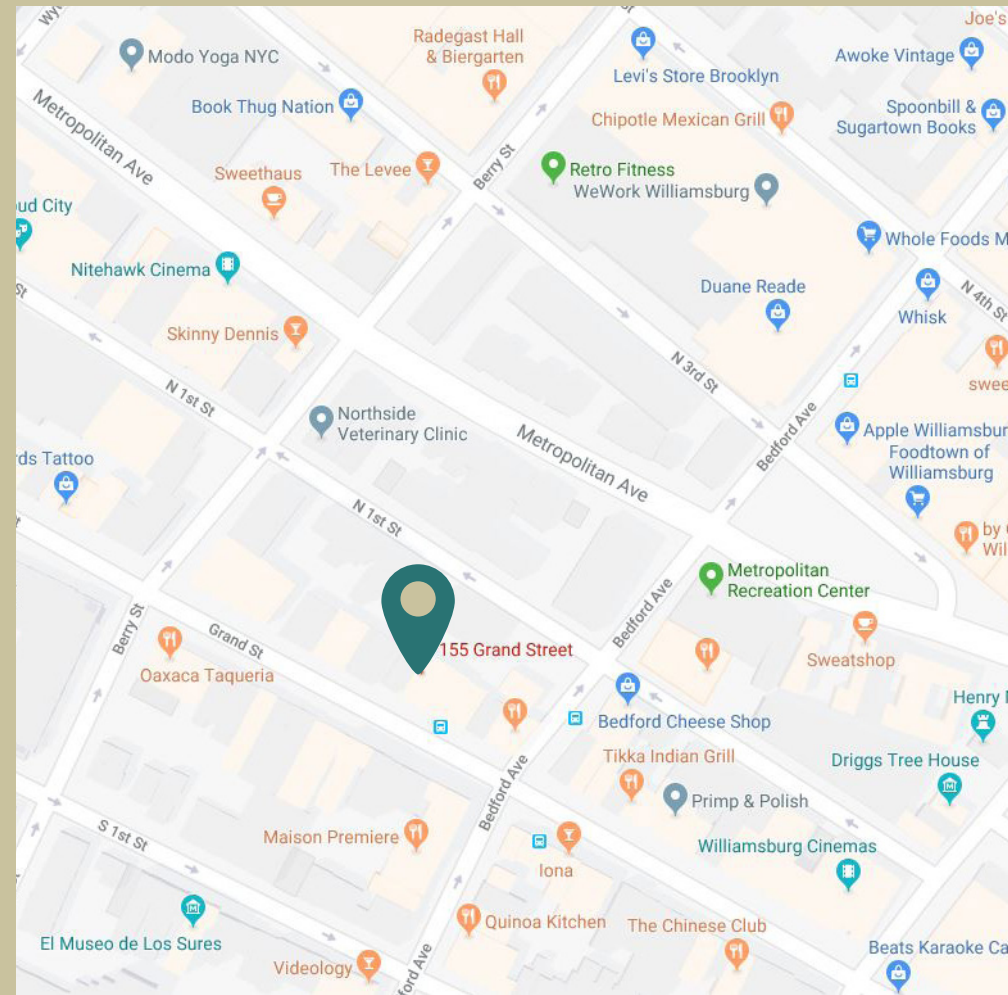

FOR MORE INFORMATION CONTACT EXCLUSIVE AGENTS:

JOSHUA SIEGELMAN
212.792.2613
jsiegelman@winick.com

IAN ZIMMERMAN
212.792.2647
izimmerman@winick.com

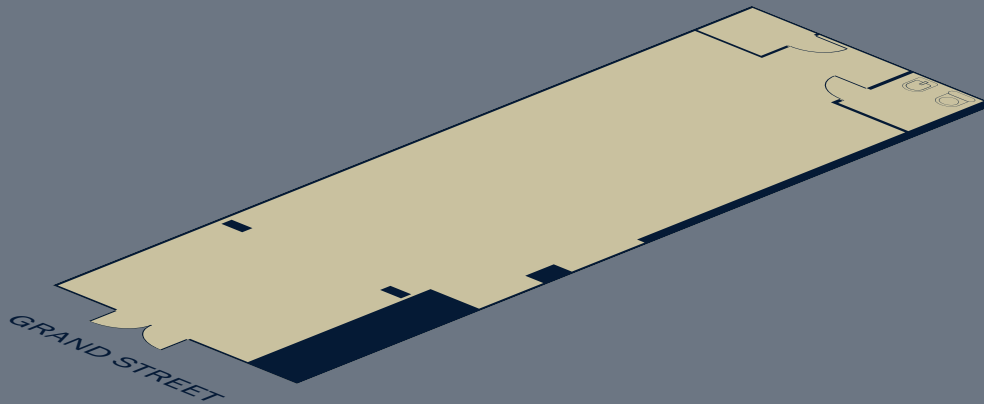

WINICK RETAIL SPECIALISTS

WINICK REALTY GROUP LLC
LICENSED REAL ESTATE BROKERS
T. 212.792.2600 F. 212.792.2660 winick.com

Although all information regarding property for sale, rental or financing is from sources deemed reliable such information has not been verified, and no express representation is made nor is any to be implied as to the accuracy thereof, and it is submitted subject to errors, omissions, change of price, rental or other conditions, prior sale, lease or financing, or withdrawal without notice.