

121 READE STREET 121

TRIBECA
NEW YORK, NY 10013



121 READE STREET

SOUTHWEST CORNER OF HUDSON STREET
NEW YORK, NY 10013

GROUND FLOOR (APPROX.)

3,400 SF

FRONTAGE (APPROX.)

100' WRAPAROUND

POSSESSION

IMMEDIATE

ASKING PRICE

UPON REQUEST

COMMENTS

- FIRST TIME AVAILABLE IN 25 YEARS
- ALL USES CONSIDERED
- LOCATED IN THE HEART OF TRIBECA

NEIGHBORS

SWEETGREEN, STARBUCKS, SERAFINA, VAN LEEUWEN,
CITIZENS BANK, JOE & THE JUICE, KINDER CARE, BONDI

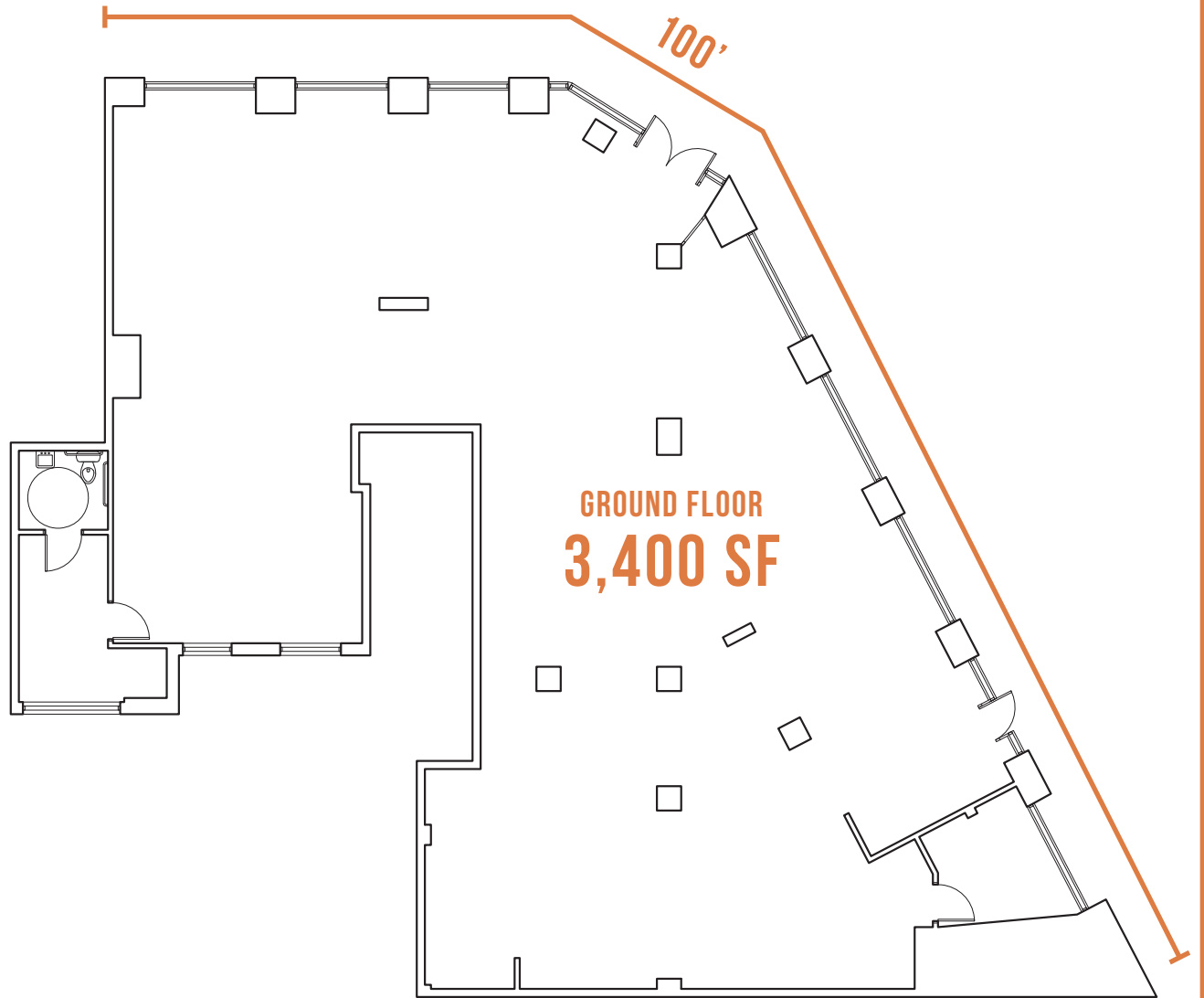



121 READE STREET

SOUTHWEST CORNER OF HUDSON STREET
NEW YORK, NY 10013

FOR MORE INFORMATION
PLEASE CONTACT OUR EXCLUSIVE BROKERS:

CHARLES RAPUANO

212.792.2658

CHARLES@WINICK.COM

STEVEN E. BAKER

212.792.2636

STEVENB@WINICK.COM

SPENCER PLANIT

212.792.2604

SPLANIT@WINICK.COM

WRG | WINICK
REALTY GROUP

Winick Realty Group LLC, Licensed Real Estate Brokers

655 Third Avenue, 24th Floor | New York, NY 10017

T 212.792.2600 | F 212.792.2660 | winick.com

ALTHOUGH ALL INFORMATION REGARDING PROPERTY FOR SALE, RENTAL OR FINANCING IS FROM SOURCES DEEMED RELIABLE SUCH INFORMATION HAS NOT BEEN VERIFIED, AND NO EXPRESS REPRESENTATION IS MADE NOR IS ANY TO BE IMPLIED AS TO THE ACCURACY THEREOF, AND IT IS SUBMITTED SUBJECT TO ERRORS, OMISSIONS, CHANGE OF PRICE, RENTAL OR OTHER CONDITIONS, PRIOR SALE, LEASE OR FINANCING, OR WITHDRAWAL WITHOUT NOTICE